

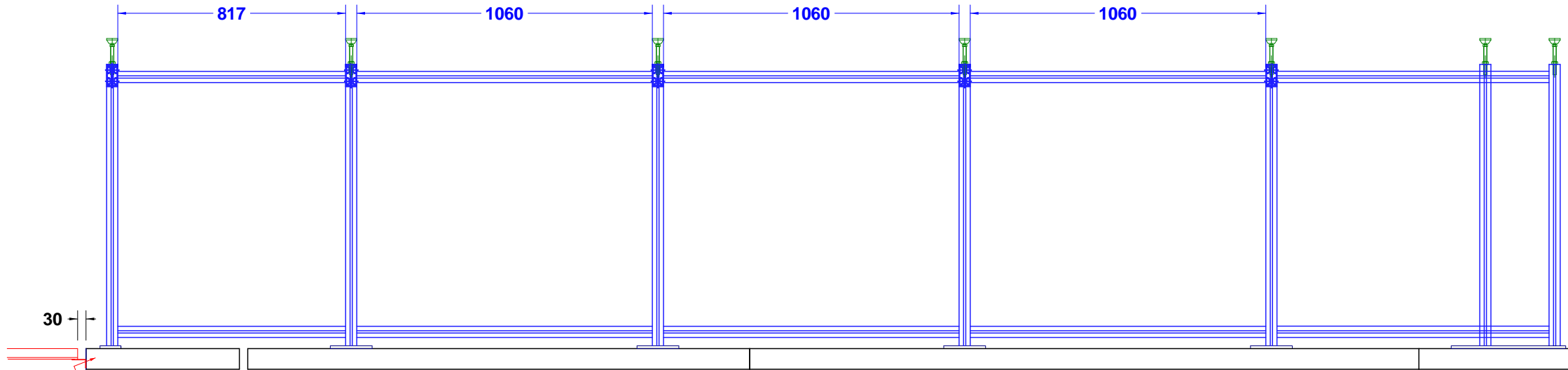

Sushi Conveyors

MONK Conveyors Ltd, Unit 9, The Christy Estate, Ivy Road, Aldershot, Hampshire GU12 4TX Tel: 01252 369800 Fax: 01252 369801
Email: sales@monk-conveyors.co.uk www.monk-conveyors.com



NOTE THIS END WILL MOVE OUTWARDS WHEN CHAIN IS REQUIRED TO BE TENSIONED ENSURE THAT THERE IS A GAP TO COUNTER TO ACCOMODATE THIS

APPROVAL DRAWING ONLY
PLEASE RETURN A COPY DULY SIGNED AND DATED TO ALLOW MANUFACTURE TO COMMENCE. EQUIPMENT WILL BE SUPPLIED AS THIS DRAWING.
SIGNED BY
DATE

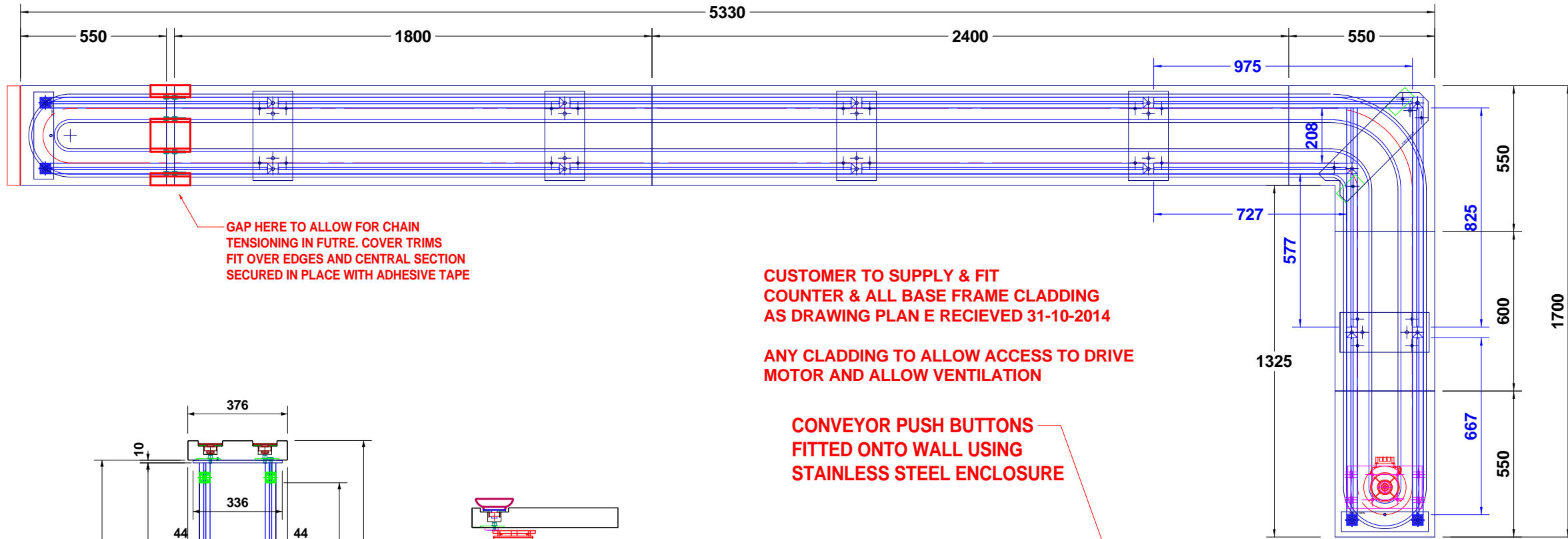

GAP HERE TO ALLOW FOR CHAIN TENSIONING IN FUTRE. COVER TRIMS FIT OVER EDGES AND CENTRAL SECTION SECURED IN PLACE WITH ADHESIVE TAPE

CUSTOMER TO SUPPLY & FIT COUNTER & ALL BASE FRAME CLADDING AS DRAWING PLAN E RECIEVED 31-10-2014

ANY CLADDING TO ALLOW ACCESS TO DRIVE MOTOR AND ALLOW VENTILATION

CONVEYOR PUSH BUTTONS FITTED ONTO WALL USING STAINLESS STEEL ENCLOSURE

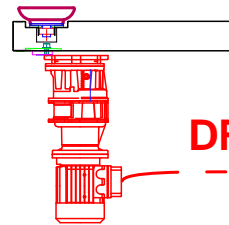
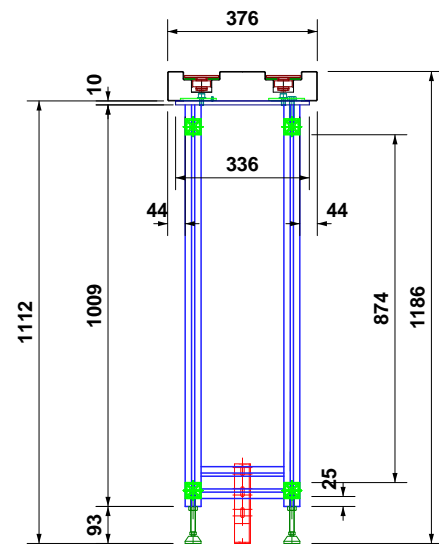

DRIVE # 1

CONTROLLER SUPPLIED LOOSE

CABLE LENGTHS
DRIVE # 1 TO INVERTER - 3 METRES
INVERTER POWER LEAD - 3 METRES
PUSH BUTTONS TO BELT INVERTER - 3 METRES

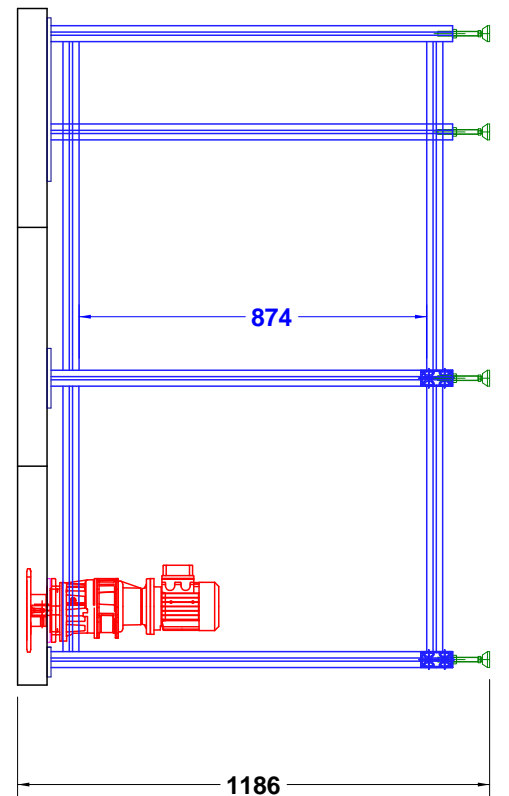

Iss 2 (7/11/2014 JS) O/ALL LENGTH INCREASED BY 30mm TO ALLOW FOR CHAIN TENSIONING

REF QS1024-C-SW

DRAWN	DATE	ISSUE	TITLE
JS	OCT 2014	2	KOBE SUSHI - EALING

KOBE SUSHI - EALING

DRAWING No
4725-000